

# The Gallery Rooms

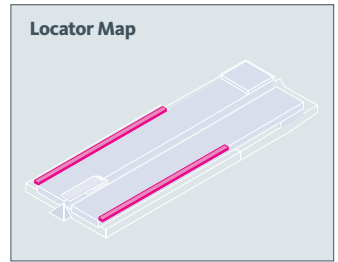

## North Gallery Rooms

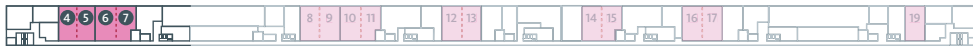

### North Gallery Rooms Sample Detail Plan: Rooms 1 to 7

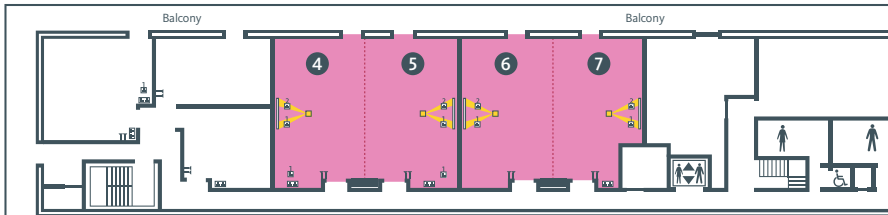

## South Gallery Rooms Sample Detail Plan: Rooms 1 to 6

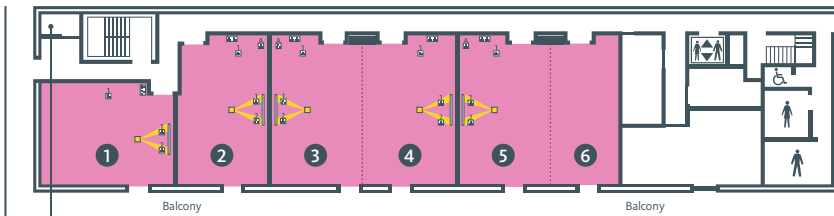

## South Gallery Rooms



## North Gallery Rooms

Maximum number of delegates in each Style

Level 2 - Meeting/Syndicate	Area	Dimensions	Height	Theatre	Classroom	Cabaret	Banquet	Reception	Boardroom
Large Single Room	97m <sup>2</sup>	12.74m x 7.61m	3.25m	90	42	*48	60	90	34
Small Single Room	71m <sup>2</sup>	12.74m x 5.58m	3.25m	70	42	*40	50	70	34
Large Double Room	194m <sup>2</sup>	12.74m x 15.22m	3.25m	200	98	*96	120	200	50
Small Double Room	168m <sup>2</sup>	12.74m x 13.19m	3.25m	180	95	*80	100	180	50
North Gallery Room 1	79m <sup>2</sup>	8.67m x 9.16m	3.25m	70	30	*50	50	70	24

\*Cabaret numbers based on a max of eight per table (using 5ft round tables)

## South Gallery Rooms

Maximum number of delegates in each Style

Level 2 - Meeting/Syndicate	Area	Dimensions	Height	Theatre	Classroom	Cabaret	Banquet	Reception	Boardroom
Large Single Room	97m <sup>2</sup>	12.74m x 7.61m	3.25m	90	40	*48	60	90	34
Small Single Room	71m <sup>2</sup>	12.74m x 5.58m	3.25m	70	28	*32	40	60	34
Large Double Room	194m <sup>2</sup>	12.74m x 15.22m	3.25m	200	98	*96	120	200	50
Small Double Room	168m <sup>2</sup>	12.74m x 13.19m	3.25m	180	80	*80	100	180	44
Premier Room 1	96m <sup>2</sup>	8.67m x 11.08m	3.25m	90	40	*48	60	90	34
Premier Room 2	95m <sup>2</sup>	7.51m x 12.74m	3.25m	80	40	*40	50	80	34
South Gallery Room 33	96m <sup>2</sup>	8.67m x 11.12m	3.25m	90	40	*48	60	90	34
Triple Room	291m <sup>2</sup>	12.74m x 22.83	3.25m	304	118	*144	180	304	60
Quadruple Room	362m <sup>2</sup>	12.74m x 28.41	3.25m	400	145	*184	230	400	70

\*Cabaret numbers based on a max of eight per table (using 5ft round tables)

## The Gallery Rooms (Level 2)

**Ceiling height**  
 • Maximum headroom: 3.25m clear to ceiling

**Door dimensions**  
 • Maximum headroom: 2m clear to ceiling  
 • Door width: 1.5m

**Maximum occupancy**  
 • Single rooms – 90 people  
 • Double rooms – 200 people

**Maximum loading**  
 • Breakout areas: 5,0kn/m<sup>2</sup>

**Facilities**  
 • Voice evacuation system  
 • Dimmable house lighting  
 • All suites are acoustically sealed  
 • All rooms have blinds  
 • Audio visual equipment available upon request

## Electric and Data Key

- Floor box type 1**  
 2 x 13 AMP power sockets  
 4 x jack plugs
- Floor box type 2**  
 2 x 13 power sockets  
 1 x 15 PIN female PC socket  
 1 x video jack  
 2 x 15 pair audio sockets (L and R)  
 1 x 13 AMP projector plug
- A-three-phase supply**  
**3 pin N.E. commando socket**  
 Available upon request
- Pair fused and switched**  
 13A sockets
- Ceiling mounted data projection**

- Projection screens**
- Partition wall**
- Toilets**  
 Men  
 Women
- Disabled**
- Public lifts**
- Light switch**